

AMERICAN SOCIETY OF BREAST SURGEONS 25th ANNUAL MEETING

ORLANDO WORLD CENTER MARRIOTT - CYPRESS BALLROOM 3 - ORLANDO, FL

ASBrS 2024 Meeting Dates: 4/10/24 - 4/14/24 / Exhibit Dates: 4/11/2024 - 4/13/2024

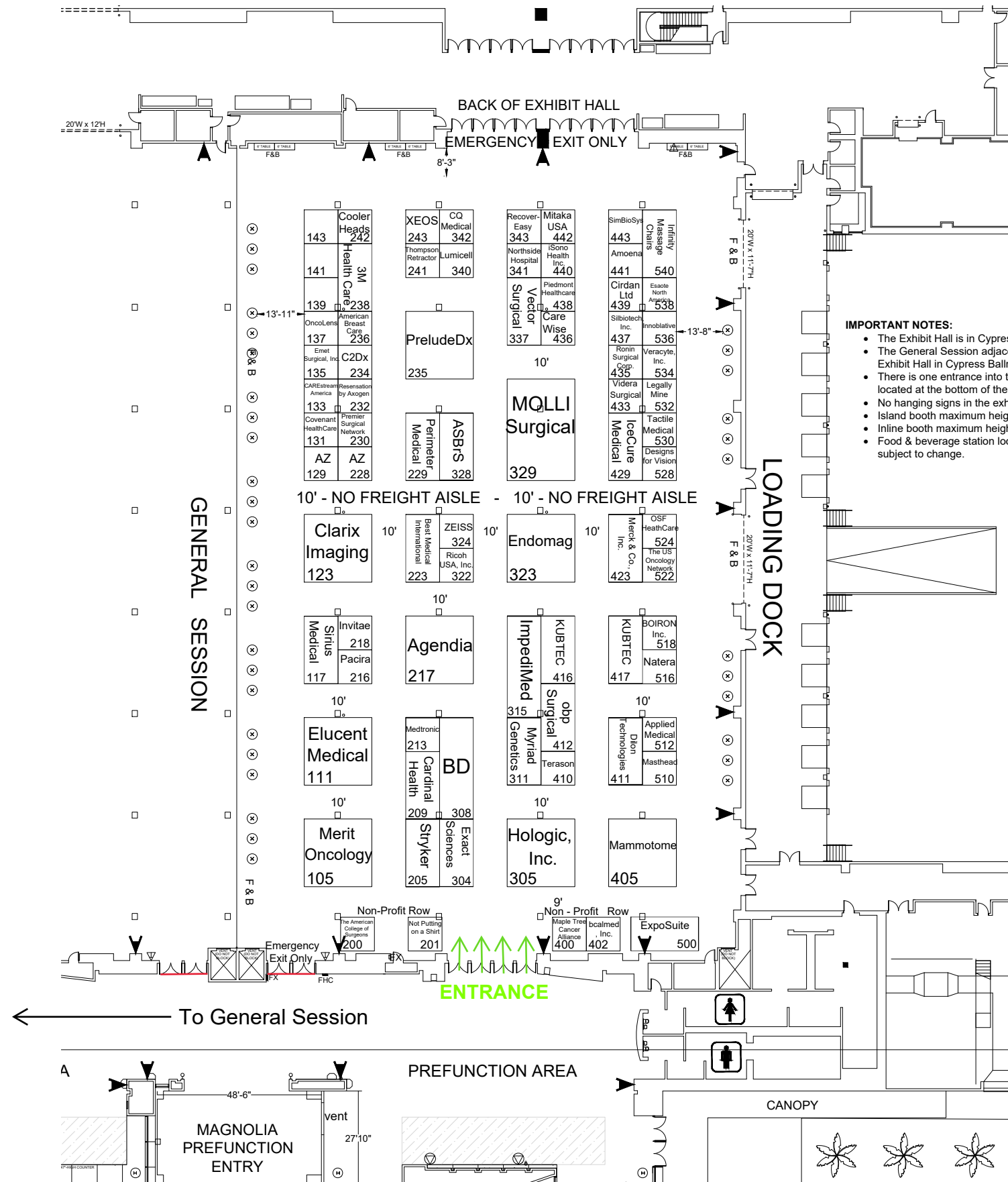

IMPORTANT NOTES:

- The Exhibit Hall is in Cypress Ballroom 3.
- The General Session adjacent to the Exhibit Hall in Cypress Ballrooms 1 & 2.
- There is one entrance into the Exhibit Hall, located at the bottom of the drawing.
- No hanging signs in the exhibit hall.
- Island booth maximum height is 16'.
- Inline booth maximum height is 8'.
- Food & beverage station locations are subject to change.

REVISION
Date: 11/7/2023
By: Wilfred Wallen

BOOTH COUNT

Inventory as of 11/07/2023

0% - 8 SqFt Rented
100% - 14,501 SqFt Available

Dimension	Size	Qty	SqFt	Rented
10'x10'	100	107	10,700	0
20'x20'	400	8	2,400	0
20'x20'	401	2	801	0
20'x30'	600	1	600	0
Totals:	116	14,501	0	0

- BLDG. LEGEND:**
- FX = FIRE EXTINGUISHER
 - FHC = FIRE HOSE CABINET
 - ▽ = FIRE STROBE = 6'-6"
 - ▲ = FIRE STROBE = 11'-6"
 - = UTILITIES FLOOR BOX WITH WATER DRAINS
 - ⊠ = UTILITIES FLOOR BOX WITH WATER DRAINS
 - △ = BUILDING SERVICE TELEPHONE
 - LCD = DIGITAL DISPLAY MONITOR
 - = CEILING DETAIL LINES

NOTE:
LCD BOX NEEDS PERMISSION TO BLOCK.

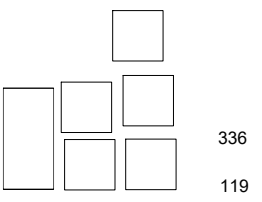
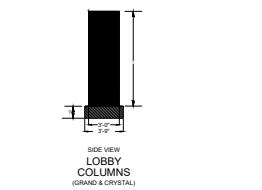

DRAWING INFO

Passport Line Item Number: 425

#107433105

Facility: 211 431

ORLANDO WORLD CENTER MARRIOTT

Facility Location: 413 339

CYPRESS FOYER

City & State: ORLANDO, FL

Scale: CUSTOM

Project #: 522988

Acct. Sales: JESIKA HAYES

Acct. Mgmt.: LYN SAMANIEGO

Started: 5/31/2023

Started By: WILFRED WALLEN

Prod. Branch: ORLANDO

Freeman.

Disclaimer - This floor plan is preliminary and subject to change pending review and official approval by all authorities having jurisdiction. Every effort has been made to ensure the accuracy of all information contained on this floor plan. However, no warranties, either expressed or implied, are made with respect to this floor plan. If the location of building columns, utilities or other architectural components of the facility is a consideration in the construction or usage of an exhibit, it is the sole responsibility of the exhibitor to physically inspect the facility to verify all dimension and locations. © Copyright 2023, Freeman Co. All rights reserved.

Confidential and Proprietary - the information contained herein is the proprietary information of Freeman and by accessing the information, the recipient agrees to keep the information confidential and not disclose it to any third party without the prior consent of Freeman. Recipient also agrees to only use the information for its internal evaluation purposes and for no other purpose, without the prior consent of Freeman.

File Path: C:\Vault\Designs\Projects\A\Am Soc Of Breast Surgeons Ann Scientific Mig\ASBSAM2404\Event\Floor Plans\ASBSAM24.dwg | Tab Name: L107433105.FP